



# Hello there!

## Welcome to the Webinar

*ADU Roundtable Conversation + Live Q&A*

December 2, 2021

  
Napa Sonoma **ADU**

# Zoom Logistics

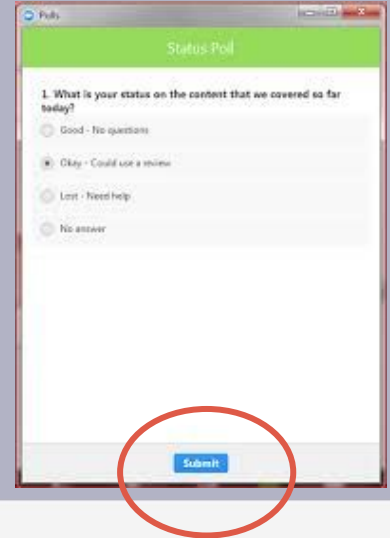
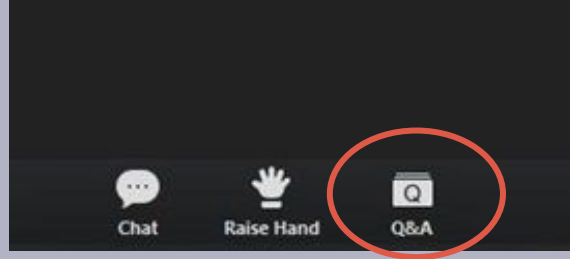
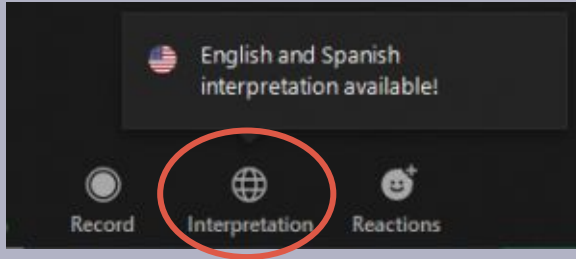

Spanish Interpretation  
(*Interpretación al español*)

Audience Q&A

Interactive polls



# Where did you learn of the webinar?

- Napa Sonoma ADU Newsletter
- Napa Sonoma ADU Webpage
- My city or county's website, newsletter or social media
- Facebook
- NextDoor
- News media source
- Word of mouth
- Another organization
- Other

# Renée J. Schomp

*Director*

Napa Sonoma ADU Center

## **E-contact:**

<https://napasonomaadu.org/stay-in-touch>

## **Phone:**

707.804.8575





# Scott Johnson

**ADU Expert,**  
*Napa Sonoma  
ADU Center*

+

**Founder,**  
*Pocket Housing LLC*





# Lindsay Moon

NMLS # 1918146, DRE # 02087248  
Licensed broker and builder

- **Email:** [lindsay@searchlightlending.com](mailto:lindsay@searchlightlending.com)
- **Phone:** 415.819.3794



**SearchLight**  
L E N D I N G

# Agenda

- **ADU Budget & financing**
  - Common financing strategies
  - Permit Fees: What are they?
- **ADU Preconstruction**
  - Government agencies
  - Utilities (energy, well, septic, etc.)
- **ADU Construction**
  - How are ADUs “eco-friendly”?
  - New developments in ADU construction

# About the Napa Sonoma ADU Center

Napa Sonoma  ADU

We're a nonprofit here to help  
Napa & Sonoma County  
homeowners build ADUs.







# Napa Sonoma ADU Resources

- ADU calculator
- Local ADU rules
- Address Lookup Tool
- ADU Workbook
- Stories & floor plans
- Webinars
- Vendor registry
- Newsletter & social media

# Support for homeowners

- **Contact Us:**  
<https://napasonomaadu.org/stay-in-touch>
- **Phone:** 707.804.8575





# ADU Feasibility Consults

**#1**  
**Questionnaire**

**# 2**  
**Prescreening**

**#3**  
**Hour-long  
site visit**

**#4**  
**ADU Feasibility  
Report**

*Sign up on our website:*  
[napasonomaadu.org/consultations](http://napasonomaadu.org/consultations)

# What type of ADU build do you think you'll choose?

- **Traditional stick build** -- construction on-site
- **Prefab Modular:** built as a complete unit in a factory and certified at the state level by HCD
- **Prefab Manufactured:** built as a complete unit in a factory and certified at the federal level by HUD
- **Prefab Panelized:** e.g., framing package, structurally insulated panels or SIPs, etc.
- **Prefab** -- I don't know the exact type



## PART 1

# ADU Budget & Financing





# Budgeting & Finance



## PART 2

# ADU Preconstruction





## Utilities

- Septic
- Sewer
- Water
- Energy

# Public & Private Agencies

- County
  - Water & Sewer Depts
    - “Well & Septic” (in Sonoma County)
    - “Environmental Health” (in Napa County)
  - Planning Dept
  - Building Dept
  - Fire Dept
- City
  - Planning Dept
  - Building Dept
  - Fire Dept
- Water districts
- PG&E



# Permit Fees

- Types of fees:
  - Impact fees (if over 750 sf)
  - Building permit fees
  - Utilities fees
  - School district fees



Photo: Abodu



## PART 3

# ADU Construction



**Eco-Friendly**





New  
construction  
developments  
coming in  
2022...



Photo: Premier SIPS



# Permit-Ready ADU Plans Program

coming soon...

# ADU Webinars

Register for upcoming webinars  
& view past webinars  
on-demand:  
[napasonomaadu.org/aduevents](http://napasonomaadu.org/aduevents)



**Past: Nov 4**

All You Need to Know  
About Prefab &  
Modular ADUs!

**Past: Nov 16**

How to Do an ADU  
Permit Application

**Jan 27**

A New Way to  
Finance Building  
Your Dream ADU!





**We are here to  
help you**

Reach out to us anytime!

[www.napasonomaadu.org](http://www.napasonomaadu.org)

<https://napasonomaadu.org/stay-in-touch>

707.804.8575

# Thanks to our supporters

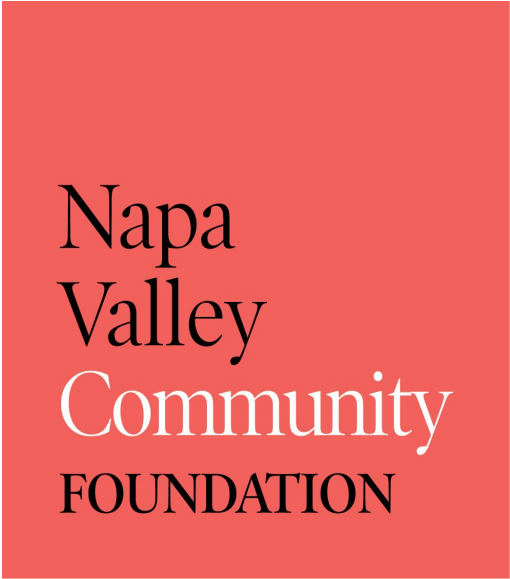

COMMUNITY  
FOUNDATION  
SONOMA  
COUNTY



**...and  
thank  
YOU!**

